

LET'S

CELEBRATE!



HOST YOUR SPECIAL EVENTS

AT THE PHILLIPS COLLECTION

PHILLIPS

The Phillips Collection

ABOUT THE PHILLIPS COLLECTION

Encounter modern and contemporary art in an intimate setting at The Phillips Collection, opened to the public in 1921 in Washington's vibrant Dupont Circle neighborhood by founder Duncan Phillips. Following the death of his father and brother with whom he shared a close relationship, he and his mother responded by founding the museum, originally called the Phillips Memorial Art Gallery. "Sorrow all but overwhelmed me," he later wrote. "Then I turned to my love of painting for the will to live." Its distinctive building combines the former home of its founder (built in 1897) with distinctive new additions (built in 1960/80 and 2006). The collection continues to grow with selective new acquisitions, many by contemporary artists from around the world. Special exhibitions and frequent changes in the arrangement of the permanent collection galleries mean that there's something fresh to see on every visit to the Phillips.

Hosting an event at the Phillips is an opportunity to gain exclusive access to the intimate galleries and take an inspirational tour through an extraordinary collection of more than 5,000 works of art collected over 100 years.





A PERSONALIZED EXPERIENCE

The Phillips Collection offers a boutique venue experience with access to its world-class art collection.

Our galleries and spaces are ideal for dinners that seat up to 60 and standing receptions up to 250. The Mansbach Auditorium accommodates 180 and the Sant Seminar Room is perfect for a meeting with up to 30 participants.

Personalization is our specialty, and we love to get creative with our clients!

Recommended capacities and suitability of spaces are included throughout this brochure. If your needs exceed these numbers or are not fully represented, we would be happy to discuss your event's priorities and how the Phillips can fulfill them. Please enquire.

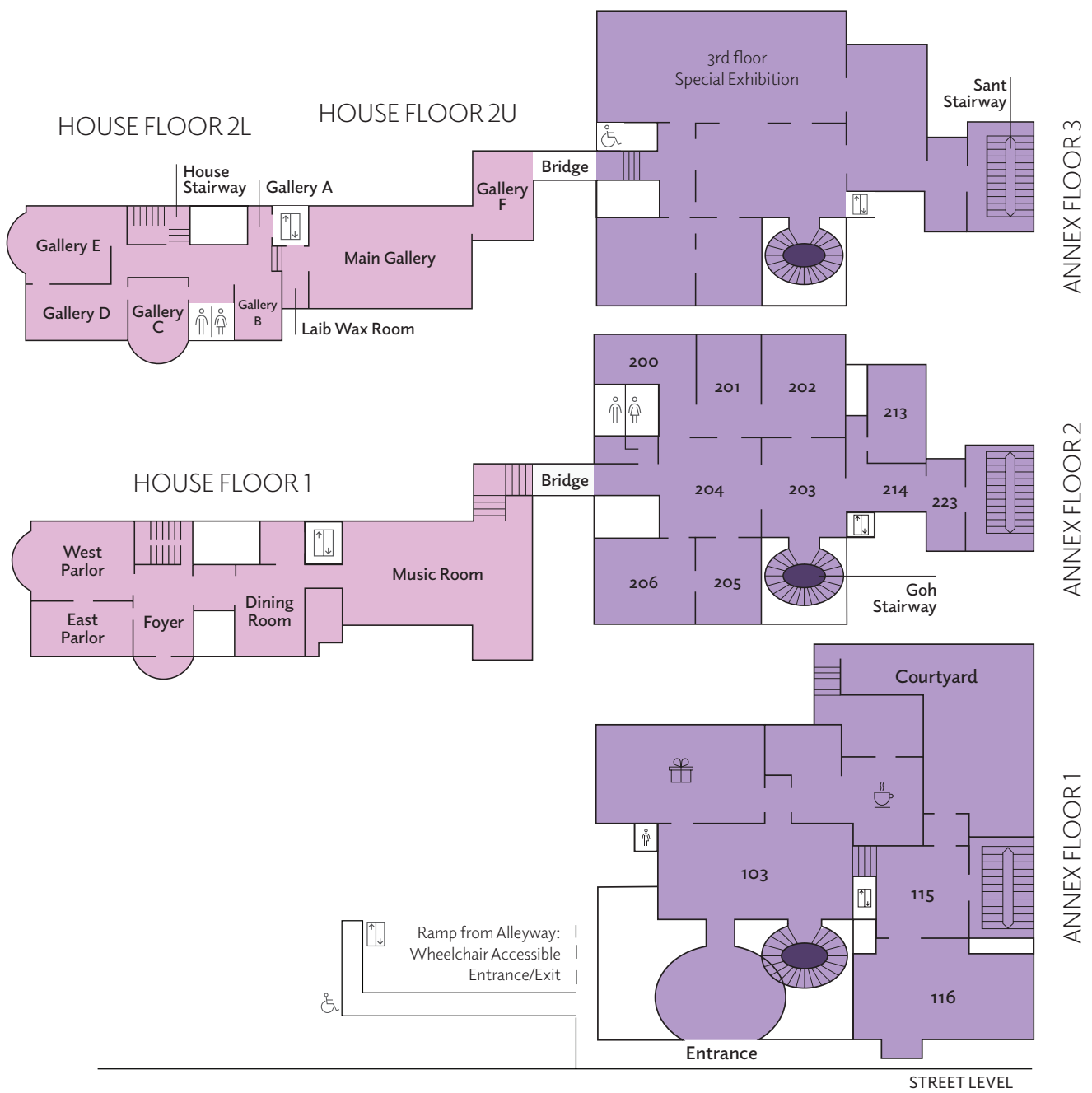

COMPREHENSIVE SITE MAP

KEY

- Elevator
- Drinking Fountain
- Restrooms
- Wheelchair Access

Coat Check at Main Entrance

Changing Tables in Lower Level and House Restrooms

- Goh Annex & Sant Building
- Phillips House

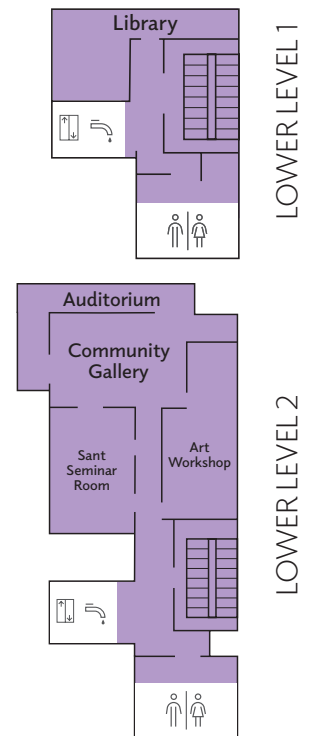

GOH ANNEX & SANT BUILDING

The Goh Annex and Sant Building hold The Gwendolyn & Morris Cafritz Gallery, the Auditorium & Sant Seminar Room, the Rothko Room, and other incredible works of art.

Floor 1

The Gwendolyn & Morris Cafritz Gallery (the Welcome Gallery) can accommodate standing receptions of up to 60 guests.



Sant Building Floor 1 Gallery



The Gwendolyn & Morris Cafritz Gallery

Lower Level 2

Lower Level 2 is the only event space that can be rented while the museum is open to the public. This floor encompasses two meeting areas, the Sant Seminar Room and Art Workshop, the Mansbach Auditorium, and reception space (the Community Gallery).

THE SANT SEMINAR ROOM AND ART WORKSHOP are well-suited for all day meetings or retreats for up to **30 people each**. Spend the day at the Phillips by ordering catering to these rooms, or rent these rooms by the hour for a shorter gathering. Add on a private tour with one of our Phillips Educators for an exclusive look at the collection to enhance your group's experience, for an additional cost.

THE MANSBACH AUDITORIUM can seat up to **180 guests**. In-house A/V staffing and equipment packages can be added for an additional fee.

THE COMMUNITY GALLERY can accommodate standing receptions of up to **180 people**. This space is perfect for receptions to follow events in the Mansbach Auditorium or a day of meetings in the Sant Seminar Room or Art Workshop.



Art Workshop



Mansbach Auditorium



Sant Seminar Room



Community Gallery / Mansbach Auditorium Reception Space



Music Room

PHILLIPS HOUSE

Music Room, Dining Room & Parlors

The Phillips House is perfect for an elegant dinner or reception with an old world feel. The House can accommodate a standing reception of **250 guests** and is ideal for more intimate configurations that will provide your guests with an unforgettable experience.

These historic rooms can be augmented with single floor Annex add-ons and/or the Mansbach Auditorium.



Dining Room



Parlors



Dining Room



Music Room



Music Room

FACILITY RENTAL RATES

AFTER MUSEUM HOURS: TUESDAY-SUNDAY, 6-10 PM

EVENT SPACE	CAPACITY & SUITABILITY	RENTAL RATE
Full Museum Phillips House, Goh Annex, and Sant Building	Capacities vary according to room Contact the Phillips for a customized proposal	\$25,000
Goh Annex (Main Building) Main floor galleries and Sant Building (upper and lower levels)	Up to 150 standing reception Seated dinners cannot be accommodated	\$13,500
Goh Annex Floor 1 Floor 1 galleries and shop	60 standing reception with optional access to the Gift Shop and two galleries	\$5,000
Sant Building - Lower Level Mansbach Auditorium, Community Gallery, Seminar Room, and Art Workshop	180 standing reception	\$5,000
Phillips House	Up to 250 standing reception Up to 60 seated dinner	\$13,500
Mansbach Auditorium Add-On	Up to 180 auditorium seats for lecture and panel discussion	\$2,000
Hunter Courtyard Add-On	50 standing reception, only eligible paired with Full Museum, Goh Annex (Main Building), and Goh Annex Floor 1 rentals	\$2,000

DURING MUSEUM HOURS: TUESDAY-SUNDAY, 10 AM-5 PM

EVENT SPACE	CAPACITY & SUITABILITY	RENTAL RATE
Sant Seminar Room	30 seated meeting around conference table with Zoom accommodations Can accommodate coffee and pastries or boxed lunches	\$500/hr
Art Workshop	30 seated for group experiences	\$500/hr
All Lower Level 2 (Auditorium, Community Gallery, Sant Seminar Room, Art Workshop)	Up to 180 standing reception	\$5,000/day

Monday rates and hours available upon request. Sunday events are unavailable during Phillips music season (September-May)

OTHER EVENT ADD-ONS

Additional gallery add-ons can be added for a max of 2 hours per event. Can only be added on to Annex or House rentals for an additional fee.

- Monday events incur an additional 25% fee, as museum is closed to the public and additional staff is required.
- A/V staffing and equipment are available, starting at \$1,500.
- Group gallery tours and workshops led by Phillips Educators can be added to your event for an additional fee, which may also include additional venue rental fees.

FAQS

- **Are there special rates?** Discounts and special access may apply for corporate partners and donors.
- **What time can I host my event?** Event start times are negotiable but must conclude by 10 pm.
- **What vendors can I use?** Please see enclosed list of approved caterers and preferred vendors.

Rates are valid as of November 2024 and subject to change until an agreement has been signed.

APPROVED CATERERS AND PREFERRED VENDORS

Clients must select vendors from our approved list of caterers and vendors. The client is responsible for coordinating with vendors.

CATERERS

Design Cuisine
Jose Duran
571.220.1867
jduran@designcuisine.com
designcuisine.com

Occasions Catering
Jullie Lucas
202.454.7804 office
202.295.7661 cell
jlucas@occasionscaterers.com
occasionscaterers.com

Relish Catering
Alison Bates
202.294.5327 cell
301.366.0823 main
abates@relishcateringdc.com

Well Dunn Catering
Cameron Doucette
202.543.7878
cdoucette@welldunn.com
welldunn.com

LIGHTING & DÉCOR

4wall
Tarik Smith
301.593.9841
tsmith@4wall.com
4wall.com

Design Foundry
Annie Senatore
240.264.1061
annie@foundrycrew.com
designfoundry.com

FLORISTS

Duran Floral Design, LLC
Erik Duran
703.455.1646 office
703.473.8902 cell
duranfloraldesign.com

Amaryllis, Inc.
Chris Vazquez
202.529.2230
c.vazquez@amaryllisdesigns.com
amaryllisflowers.com

PHOTOGRAPHY

Pixelme Studios
Pepe Gomez
202.333.8860
pepe@pixelme.net
pixelme.net

Ben Droz
412.805.0087
photos@bendroz.com
bendroz.com

Alexander Morozov
443.858.8743
photographybyalexander@gmail.com
photographybyalexander.com

MUSICIANS

Bialek's Music
Bands and DJs
Ray Bialek
301.340.6206
info@bialeksmusic.com
bialeksmusic.com

VALET PARKING

MJ Valet, LLC
Michael Jasser
202.587.2745
mjasser@mjvalet.com
mjvalet.com

PUBLIC PARKING

The Ven Embassy Row Hotel
2105 Massachusetts Avenue, NW
Washington, DC 20008
202.265.1600

Spot Hero
<https://spothero.com/destination/washington-dc/phillips-collection-parking>

EVENT PRODUCERS

The EnVISION Firm
Raven White
703.957.8848
Raven@EnVISIONFirm.com

Linder Global
Stephanie Thompson
202.285.1272
sthompson@linderglobal.com

Stratus Firm
Zach Webber
202.505.1985
zwebber@stratusfirm.com

COLLECTION HIGHLIGHTS

The Phillips Collection has been collecting modern and contemporary art for over one hundred years. Here are a few highlights from the collection.

JACOB LAWRENCE'S *MIGRATION SERIES*

Through a series of 60 panels created in 1940-41, Jacob Lawrence portrays the Great Migration, the flight of over a million African Americans from the rural South to the industrial North following the outbreak of World War I. With bold and rhythmic colors and shapes Lawrence tells a story that reminds us of our shared history and at the same time invites us to reflect on the universal theme of struggle in the world today.

THE ROTHKO ROOM

The intimate Rothko Room holds four paintings by Mark Rothko, and reflects the artist's preference for exhibiting his art "in a scale of normal living." In 1960, Duncan Phillips designated a specific room for Rothko's paintings, making the Phillips the first American museum to dedicate a space to the artist's work. The space set a standard for future commissions for the artist in other locations.

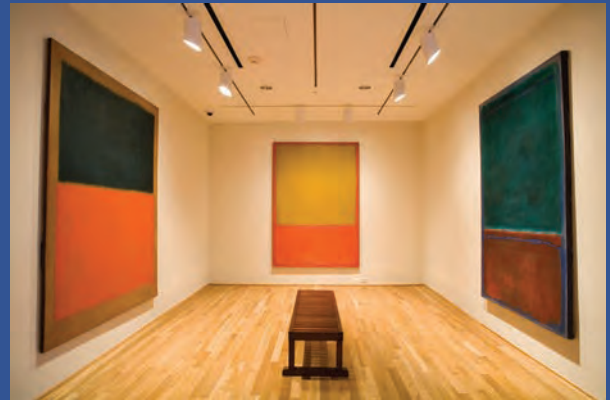

PIERRE-AUGUSTE RENOIR'S *LUNCHEON OF THE BOATING PARTY*

Luncheon of the Boating Party (1880-81) by Pierre-Auguste Renoir remains the best known and most popular work of art at The Phillips Collection, just as Duncan Phillips imagined it would be when he bought it in 1923. The painting captures an idyllic atmosphere as Renoir's friends share food, wine, and conversation on a balcony overlooking the Seine at the Maison Fournaise restaurant in Chatou.

LAIB WAX ROOM

The Laib Wax Room, lined with fragrant beeswax and illuminated by a single bare light bulb, is the first permanently installed artwork at the Phillips since the Rothko Room. The Laib Wax Room is also the first wax room that Laib created for a specific museum. Accommodating one to two people at a time, it offers a personal, meditative encounter.

NEKISHA DURRETT'S *AIRSHAFT*

The Phillips Collection commissioned bold, site-specific installations by DC-based artists as part of its centennial celebrations in 2021. Nekisha Durrett's "stained glass" design made of colorful, translucent window film creates a sacred space on the two bridges of The Phillips Collection. Titled *Airshaft*, the modernist work is influenced by Jacob Lawrence's *Migration Series* and Duke Ellington's *Harlem Airshaft*.



WE CAN'T WAIT TO WELCOME YOU!

eventrentals@phillipscollection.org

202.387.2151 x267

PHILLIPS

The Phillips Collection

1600 21st Street, NW
Washington, DC

PhillipsCollection.org